

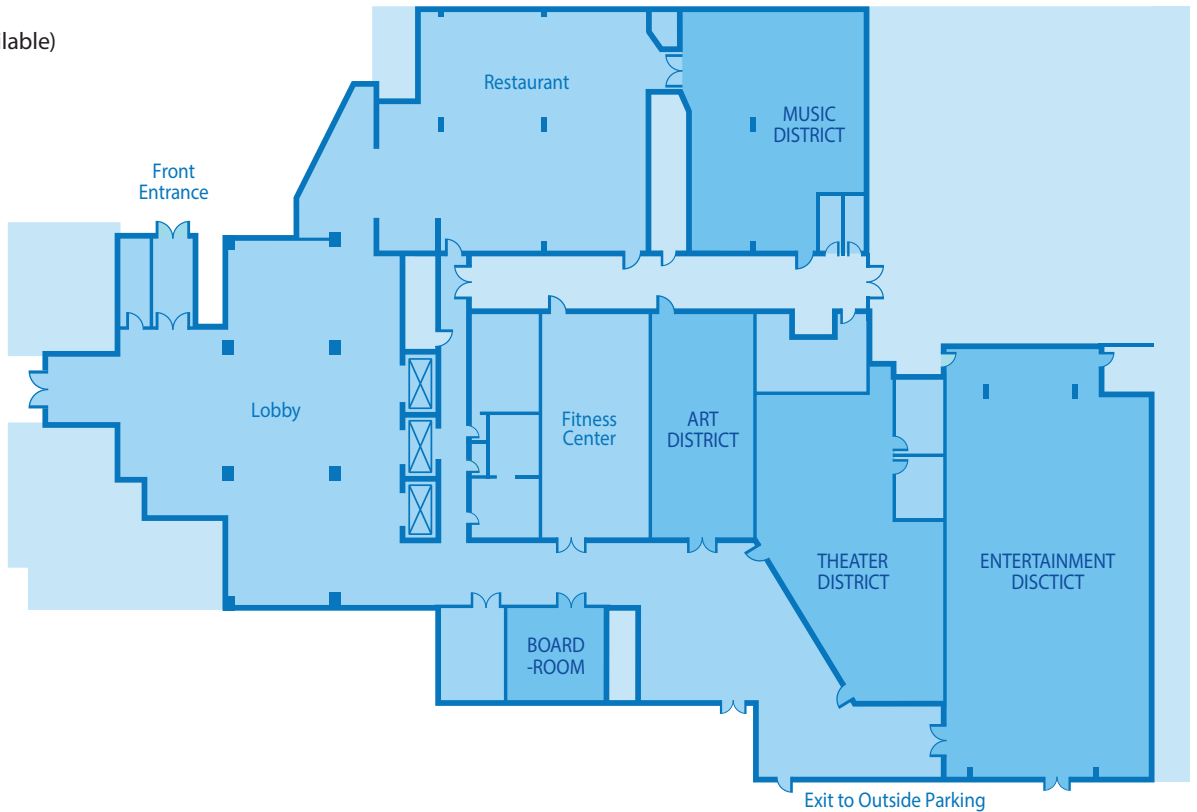

HIGHLIGHTS:

- 10,000 square feet of flexible meeting space
- Tiered-level amphitheater
- 5 distinct meeting rooms
- Audiovisual equipment and support available
- On-site catering
- 287 rooms and suites (connecting rooms available)



CAPACITY BY LAYOUT:

| Meeting Room Names | Boardroom Style | Hollow Square Style | U-Shape Style | Classroom Style | Banquet Style | Reception Style | Theatre Style | Cabaret Style |
|------------------------|-----------------|---------------------|---------------|-----------------|---------------|-----------------|---------------|---------------|
| Theater District | -- | -- | -- | 90 | -- | -- | 90 | -- |
| Board Room | 14 | -- | -- | -- | -- | -- | -- | -- |
| Arts District | 40 | 40 | 35 | 60 | 50 | 75 | 100 | 75 |
| Music District | 30 | 30 | 25 | 40 | 70 | 80 | 80 | 80 |
| Entertainment District | 40 | 60 | 50 | 175 | 250 | 300 | 300 | -- |